

# CITY OF KELOWNA

## BYLAW NO. 9290

### **Z04 – 0030 – 427743 BC Ltd. – (Emil Anderson Construction Co. Ltd./Mike Jacobs) – 543 South Crest Drive**

---

A bylaw to amend the "City of Kelowna Zoning Bylaw No. 8000".

The Municipal Council of the City of Kelowna, in open meeting assembled, enacts as follows:

1. THAT City of Kelowna Zoning Bylaw No. 8000 be amended by changing the zoning classification of part of Lot B, Section 24, Township 28, SDYD, Plan 20848 located on South Crest Drive, Kelowna, B.C., from the A1 – Agriculture 1 zone to the P3 – Parks & Open Space, RM3 – Low Density Multiple Housing, and RU2 – Medium Lot Housing zone as per Map "A" attached.
2. This bylaw shall come into full force and effect and is binding on all persons as and from the date of adoption.

Read a first time by the Municipal Council this

Considered at a Public Hearing on the

Read a second and third time by the Municipal Council this

Approved under The Highways Act this

Adopted by the Municipal Council of the City of Kelowna this

---

Mayor

---

City Clerk

# MAP A

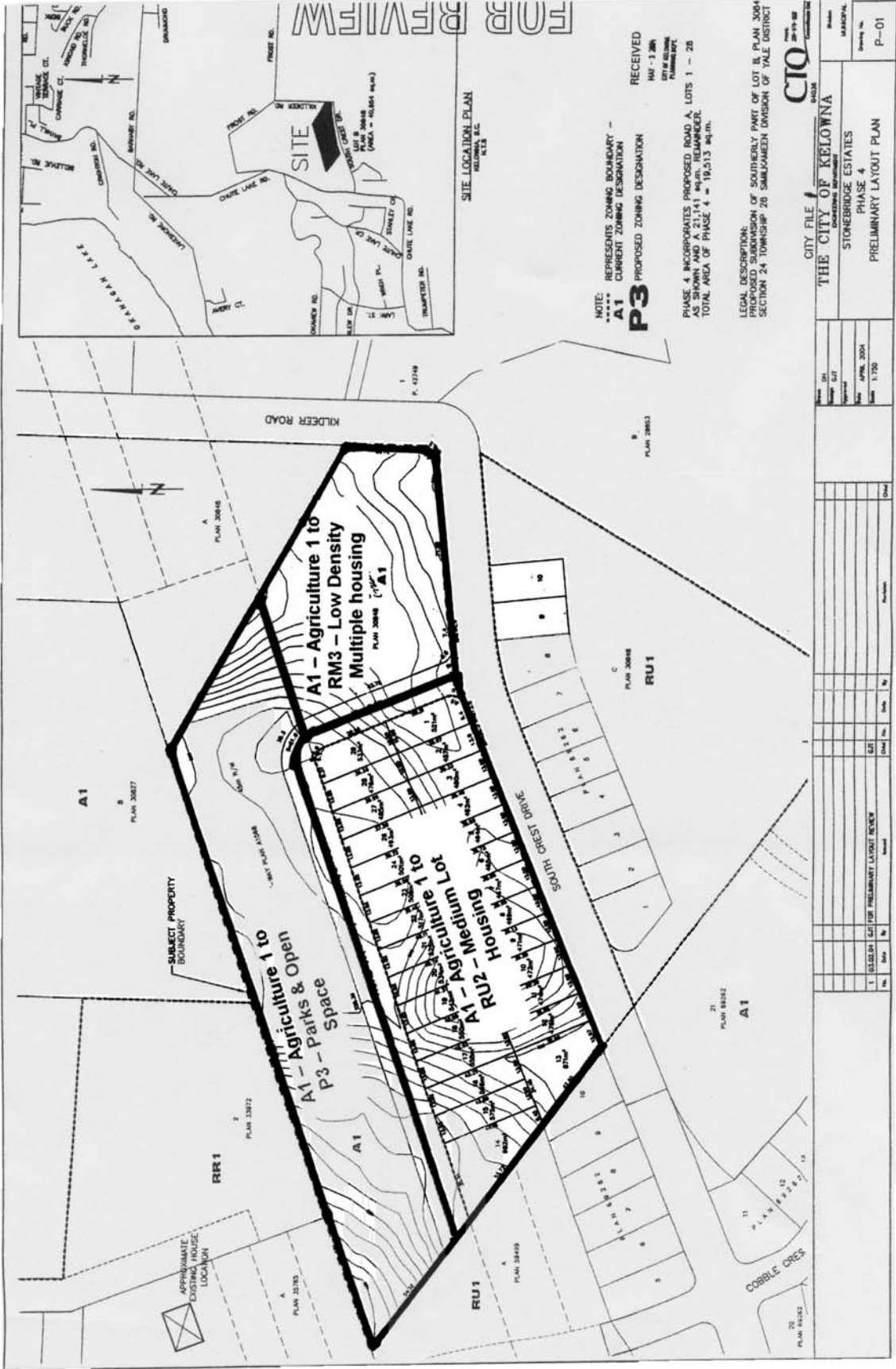

NOTE: REPRESENTS ZONING BOUNDARY -  
 \*\*\*\*\* CURRENT ZONING DESIGNATION  
**A1**  
**P3** PROPOSED ZONING DESIGNATION

RECEIVED  
 MAY - 3 2004  
 CITY OF KELOWNA  
 PLANNING DEPT.

PHASE 4 INCORPORATES PROPOSED ROAD A, LOTS 1 - 28 AS SHOWN AND A 21,141 sq.m. REMAINDER. TOTAL AREA OF PHASE 4 = 19,313 sq.m.

LEGAL DESCRIPTION:  
 PROPOSED SUBDIVISION OF SOUTHERLY PART OF LOT B, PLAN 3084 AS SHOWN AND A 21,141 sq.m. REMAINDER, SECTION 24 TOWNSHIP 20 S46M14EEN DIVISION OF YALE DISTRICT

**CIO** CITY OF KELOWNA  
 COMMUNITY DEVELOPMENT DEPARTMENT

**THE CITY OF KELOWNA**  
 STONEBRIDGE ESTATES  
 PHASE 4  
 PRELIMINARY LAYOUT PLAN

Project No. P-01

Item	Qty	Unit	Value
1	1	SET FOR PRELIMINARY LAYOUT REVIEW	5.00
2	1	SET FOR PRELIMINARY LAYOUT REVIEW	5.00
3	1	SET FOR PRELIMINARY LAYOUT REVIEW	5.00
4	1	SET FOR PRELIMINARY LAYOUT REVIEW	5.00
5	1	SET FOR PRELIMINARY LAYOUT REVIEW	5.00
6	1	SET FOR PRELIMINARY LAYOUT REVIEW	5.00
7	1	SET FOR PRELIMINARY LAYOUT REVIEW	5.00
8	1	SET FOR PRELIMINARY LAYOUT REVIEW	5.00
9	1	SET FOR PRELIMINARY LAYOUT REVIEW	5.00
10	1	SET FOR PRELIMINARY LAYOUT REVIEW	5.00
11	1	SET FOR PRELIMINARY LAYOUT REVIEW	5.00
12	1	SET FOR PRELIMINARY LAYOUT REVIEW	5.00
13	1	SET FOR PRELIMINARY LAYOUT REVIEW	5.00
14	1	SET FOR PRELIMINARY LAYOUT REVIEW	5.00
15	1	SET FOR PRELIMINARY LAYOUT REVIEW	5.00
16	1	SET FOR PRELIMINARY LAYOUT REVIEW	5.00
17	1	SET FOR PRELIMINARY LAYOUT REVIEW	5.00
18	1	SET FOR PRELIMINARY LAYOUT REVIEW	5.00
19	1	SET FOR PRELIMINARY LAYOUT REVIEW	5.00
20	1	SET FOR PRELIMINARY LAYOUT REVIEW	5.00
21	1	SET FOR PRELIMINARY LAYOUT REVIEW	5.00
22	1	SET FOR PRELIMINARY LAYOUT REVIEW	5.00
23	1	SET FOR PRELIMINARY LAYOUT REVIEW	5.00
24	1	SET FOR PRELIMINARY LAYOUT REVIEW	5.00
25	1	SET FOR PRELIMINARY LAYOUT REVIEW	5.00
26	1	SET FOR PRELIMINARY LAYOUT REVIEW	5.00
27	1	SET FOR PRELIMINARY LAYOUT REVIEW	5.00
28	1	SET FOR PRELIMINARY LAYOUT REVIEW	5.00
29	1	SET FOR PRELIMINARY LAYOUT REVIEW	5.00
30	1	SET FOR PRELIMINARY LAYOUT REVIEW	5.00
31	1	SET FOR PRELIMINARY LAYOUT REVIEW	5.00
32	1	SET FOR PRELIMINARY LAYOUT REVIEW	5.00
33	1	SET FOR PRELIMINARY LAYOUT REVIEW	5.00
34	1	SET FOR PRELIMINARY LAYOUT REVIEW	5.00
35	1	SET FOR PRELIMINARY LAYOUT REVIEW	5.00
36	1	SET FOR PRELIMINARY LAYOUT REVIEW	5.00
37	1	SET FOR PRELIMINARY LAYOUT REVIEW	5.00
38	1	SET FOR PRELIMINARY LAYOUT REVIEW	5.00
39	1	SET FOR PRELIMINARY LAYOUT REVIEW	5.00
40	1	SET FOR PRELIMINARY LAYOUT REVIEW	5.00
41	1	SET FOR PRELIMINARY LAYOUT REVIEW	5.00
42	1	SET FOR PRELIMINARY LAYOUT REVIEW	5.00
43	1	SET FOR PRELIMINARY LAYOUT REVIEW	5.00
44	1	SET FOR PRELIMINARY LAYOUT REVIEW	5.00
45	1	SET FOR PRELIMINARY LAYOUT REVIEW	5.00
46	1	SET FOR PRELIMINARY LAYOUT REVIEW	5.00
47	1	SET FOR PRELIMINARY LAYOUT REVIEW	5.00
48	1	SET FOR PRELIMINARY LAYOUT REVIEW	5.00
49	1	SET FOR PRELIMINARY LAYOUT REVIEW	5.00
50	1	SET FOR PRELIMINARY LAYOUT REVIEW	5.00
51	1	SET FOR PRELIMINARY LAYOUT REVIEW	5.00
52	1	SET FOR PRELIMINARY LAYOUT REVIEW	5.00
53	1	SET FOR PRELIMINARY LAYOUT REVIEW	5.00
54	1	SET FOR PRELIMINARY LAYOUT REVIEW	5.00
55	1	SET FOR PRELIMINARY LAYOUT REVIEW	5.00
56	1	SET FOR PRELIMINARY LAYOUT REVIEW	5.00
57	1	SET FOR PRELIMINARY LAYOUT REVIEW	5.00
58	1	SET FOR PRELIMINARY LAYOUT REVIEW	5.00
59	1	SET FOR PRELIMINARY LAYOUT REVIEW	5.00
60	1	SET FOR PRELIMINARY LAYOUT REVIEW	5.00
61	1	SET FOR PRELIMINARY LAYOUT REVIEW	5.00
62	1	SET FOR PRELIMINARY LAYOUT REVIEW	5.00
63	1	SET FOR PRELIMINARY LAYOUT REVIEW	5.00
64	1	SET FOR PRELIMINARY LAYOUT REVIEW	5.00
65	1	SET FOR PRELIMINARY LAYOUT REVIEW	5.00
66	1	SET FOR PRELIMINARY LAYOUT REVIEW	5.00
67	1	SET FOR PRELIMINARY LAYOUT REVIEW	5.00
68	1	SET FOR PRELIMINARY LAYOUT REVIEW	5.00
69	1	SET FOR PRELIMINARY LAYOUT REVIEW	5.00
70	1	SET FOR PRELIMINARY LAYOUT REVIEW	5.00
71	1	SET FOR PRELIMINARY LAYOUT REVIEW	5.00
72	1	SET FOR PRELIMINARY LAYOUT REVIEW	5.00
73	1	SET FOR PRELIMINARY LAYOUT REVIEW	5.00
74	1	SET FOR PRELIMINARY LAYOUT REVIEW	5.00
75	1	SET FOR PRELIMINARY LAYOUT REVIEW	5.00
76	1	SET FOR PRELIMINARY LAYOUT REVIEW	5.00
77	1	SET FOR PRELIMINARY LAYOUT REVIEW	5.00
78	1	SET FOR PRELIMINARY LAYOUT REVIEW	5.00
79	1	SET FOR PRELIMINARY LAYOUT REVIEW	5.00
80	1	SET FOR PRELIMINARY LAYOUT REVIEW	5.00
81	1	SET FOR PRELIMINARY LAYOUT REVIEW	5.00
82	1	SET FOR PRELIMINARY LAYOUT REVIEW	5.00
83	1	SET FOR PRELIMINARY LAYOUT REVIEW	5.00
84	1	SET FOR PRELIMINARY LAYOUT REVIEW	5.00
85	1	SET FOR PRELIMINARY LAYOUT REVIEW	5.00
86	1	SET FOR PRELIMINARY LAYOUT REVIEW	5.00
87	1	SET FOR PRELIMINARY LAYOUT REVIEW	5.00
88	1	SET FOR PRELIMINARY LAYOUT REVIEW	5.00
89	1	SET FOR PRELIMINARY LAYOUT REVIEW	5.00
90	1	SET FOR PRELIMINARY LAYOUT REVIEW	5.00
91	1	SET FOR PRELIMINARY LAYOUT REVIEW	5.00
92	1	SET FOR PRELIMINARY LAYOUT REVIEW	5.00
93	1	SET FOR PRELIMINARY LAYOUT REVIEW	5.00
94	1	SET FOR PRELIMINARY LAYOUT REVIEW	5.00
95	1	SET FOR PRELIMINARY LAYOUT REVIEW	5.00
96	1	SET FOR PRELIMINARY LAYOUT REVIEW	5.00
97	1	SET FOR PRELIMINARY LAYOUT REVIEW	5.00
98	1	SET FOR PRELIMINARY LAYOUT REVIEW	5.00
99	1	SET FOR PRELIMINARY LAYOUT REVIEW	5.00
100	1	SET FOR PRELIMINARY LAYOUT REVIEW	5.00